

MISSISSAUGA

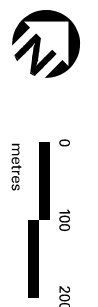

MAP 09

PORTABLE SIGN LOCATION MAP

LEGEND

- RA - DELINEATED ROAD ALLOWANCES
- ALLOCATED SITES FOR EXCLUSIVE USE BY:
 - WC - WARD COUNCILLOR
 - COMS - COMMUNITY SERVICES DEPARTMENT
 - TW - TRANSPORTATION AND WORKS DEPARTMENT
 - CORPS - CORPORATE SERVICES DEPARTMENT - COMMUNICATION DIVISION
- REG - REGION OF PEEL
- WARD BOUNDARY
- GREENBELT
- COMMUNITY PARKLAND
- DESTINATION PARKLAND
- NON ACCESSIBLE GREENBELT
- PARK UNDER CONSTRUCTION
- CITY OWNED PROPERTIES

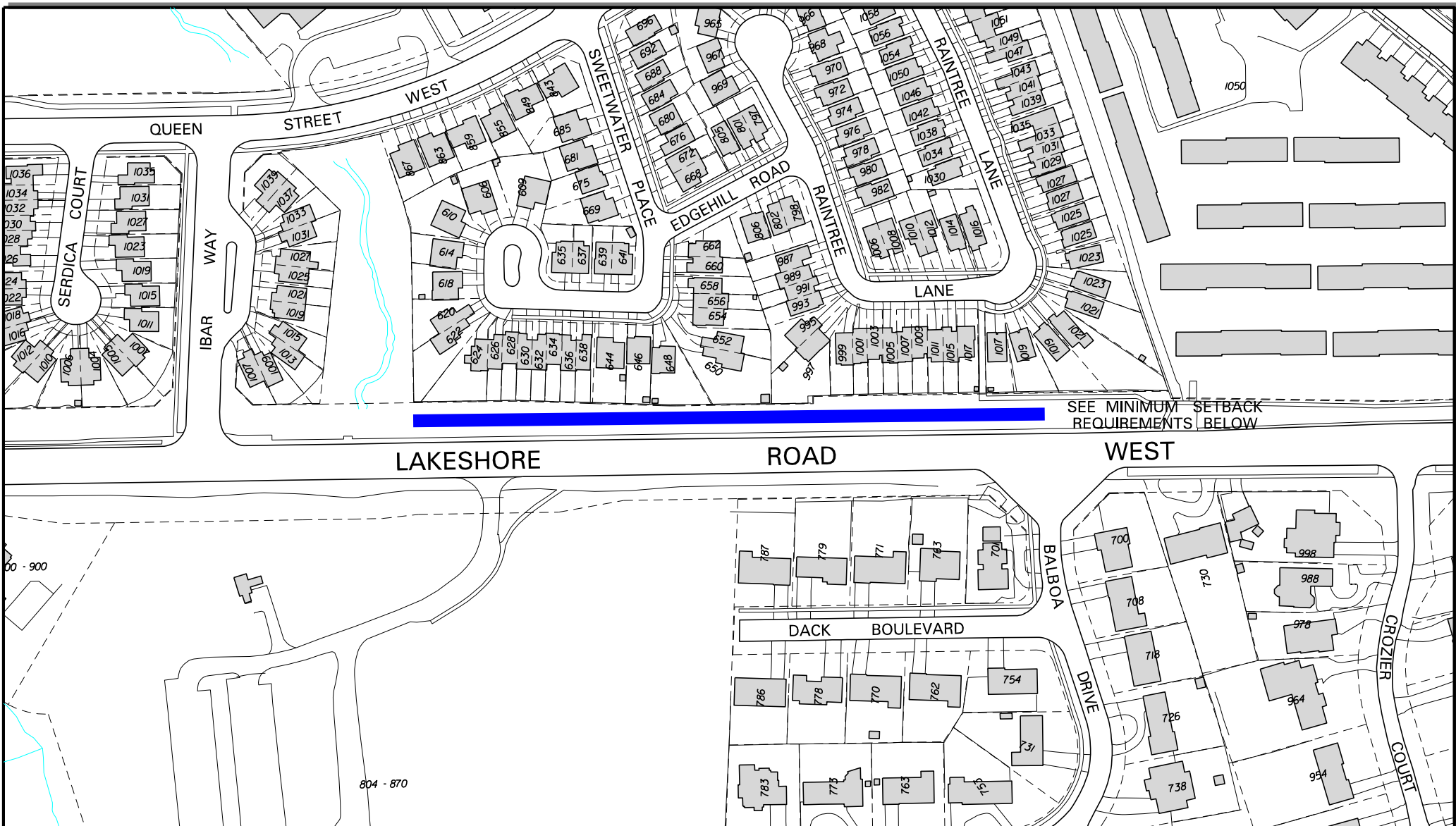

SITE No. 0902 – COMMUNITY SERVICES

MINIMUM SETBACK REQUIREMENTS		
	Arterial/Major Collector Roads	Collector/Local Roads
Minimum Setback from Sidewalk	1.0 metres (3 feet)	1.0 metres (3 feet)
Minimum Setback from Curb/Shoulder	1.5 metres (5 feet)	1.5 metres (5 feet)
Minimum Distance from Intersection	70 metres (230 feet)	45 metres (148 feet)
Minimum Distance from Driveway	70 metres (230 feet)	45 metres (148 feet)
Minimum Distance between Portable Signs	90 metres (300 feet) (on same side of the street)	90 metres (300 feet) (on same side of the street)

Proposed Sign Location

- The portable sign shall be placed so as not to obstruct:
- the sight lines of any pedestrian, cyclist, or motorist; or
 - visibility of any traffic sign or device; or
 - visibility of a bus stop or bus shelter; or
 - maintenance activities on the road allowance.

NOTE: This site is represented by a coloured dot on Portable Sign Location Map Z-09. This map can be viewed on the City's Web Site at <http://www.mississauga.ca/portal/services/maps>

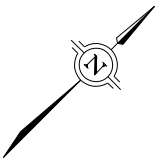

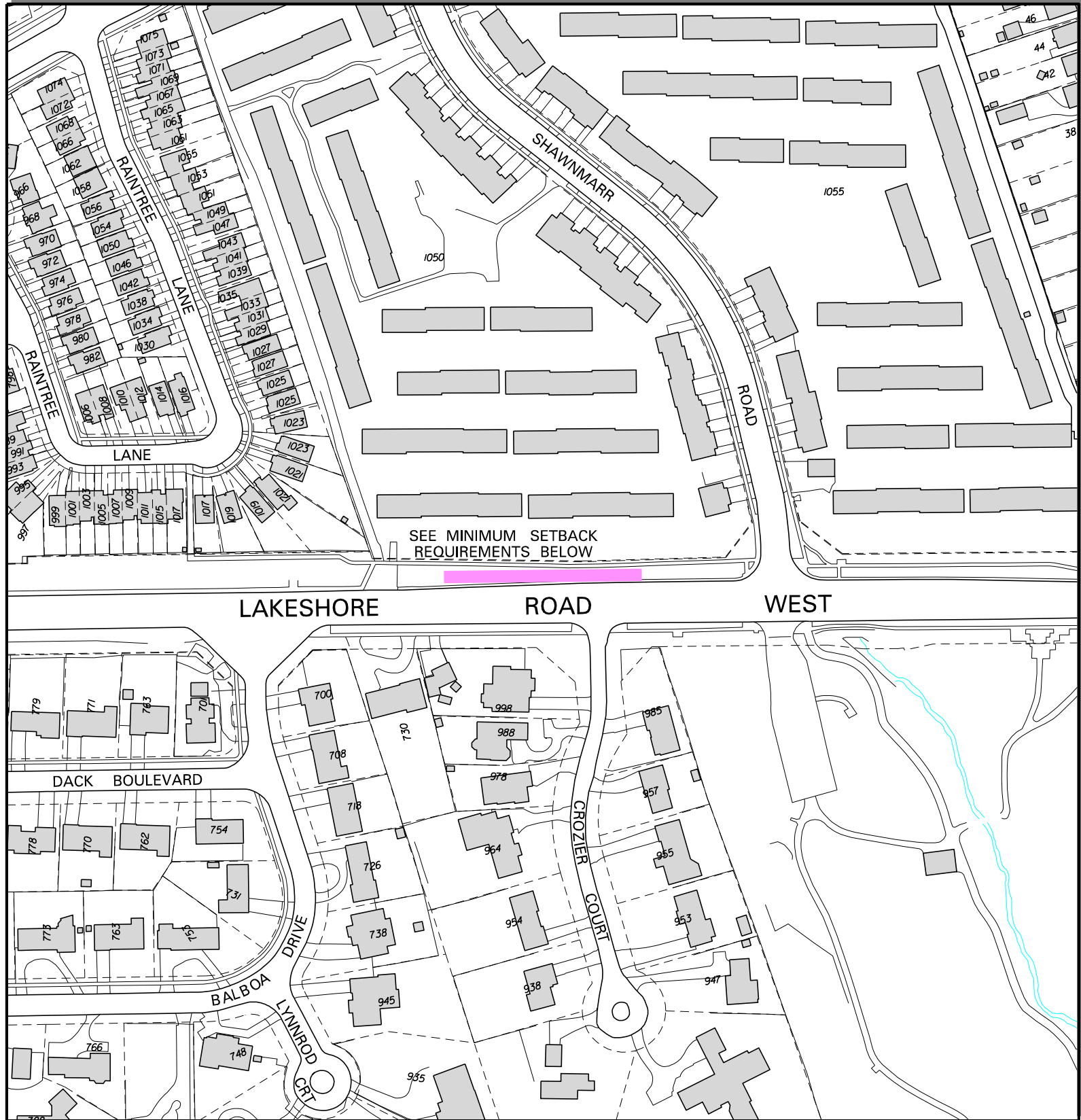

SEE MINIMUM SETBACK REQUIREMENTS BELOW

LAKESHORE ROAD WEST

SITE No. 0903 – CORPORATE SERVICES – Communication Division

MINIMUM SETBACK REQUIREMENTS

	Arterial/Major Collector Roads	Collector/Local Roads
Minimum Setback from Sidewalk	1.0 metres (3 feet)	1.0 metres (3 feet)
Minimum Setback from Curb/Shoulder	1.5 metres (5 feet)	1.5 metres (5 feet)
Minimum Distance from Intersection	70 metres (230 feet)	45 metres (148 feet)
Minimum Distance from Driveway	70 metres (230 feet)	45 metres (148 feet)
Minimum Distance between Portable Signs	90 metres (300 feet) (on same side of the street)	90 metres (300 feet) (on same side of the street)

 Proposed Sign Location

The portable sign shall be placed so as not to obstruct:

- the sight lines of any pedestrian, cyclist, or motorist; or
- visibility of any traffic sign or device; or
- visibility of a bus stop or bus shelter; or
- maintenance activities on the road allowance.

NOTE: This site is represented by a coloured dot on Portable Sign Location Map Z-09. This map can be viewed on the City's Web Site at <http://www.mississauga.ca/portals/services/maps>

PRODUCED FOR THE PLANNING AND BUILDING DEPARTMENT
By CPS, Geospatial Solutions

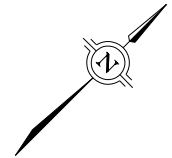

Revised: 2021 April

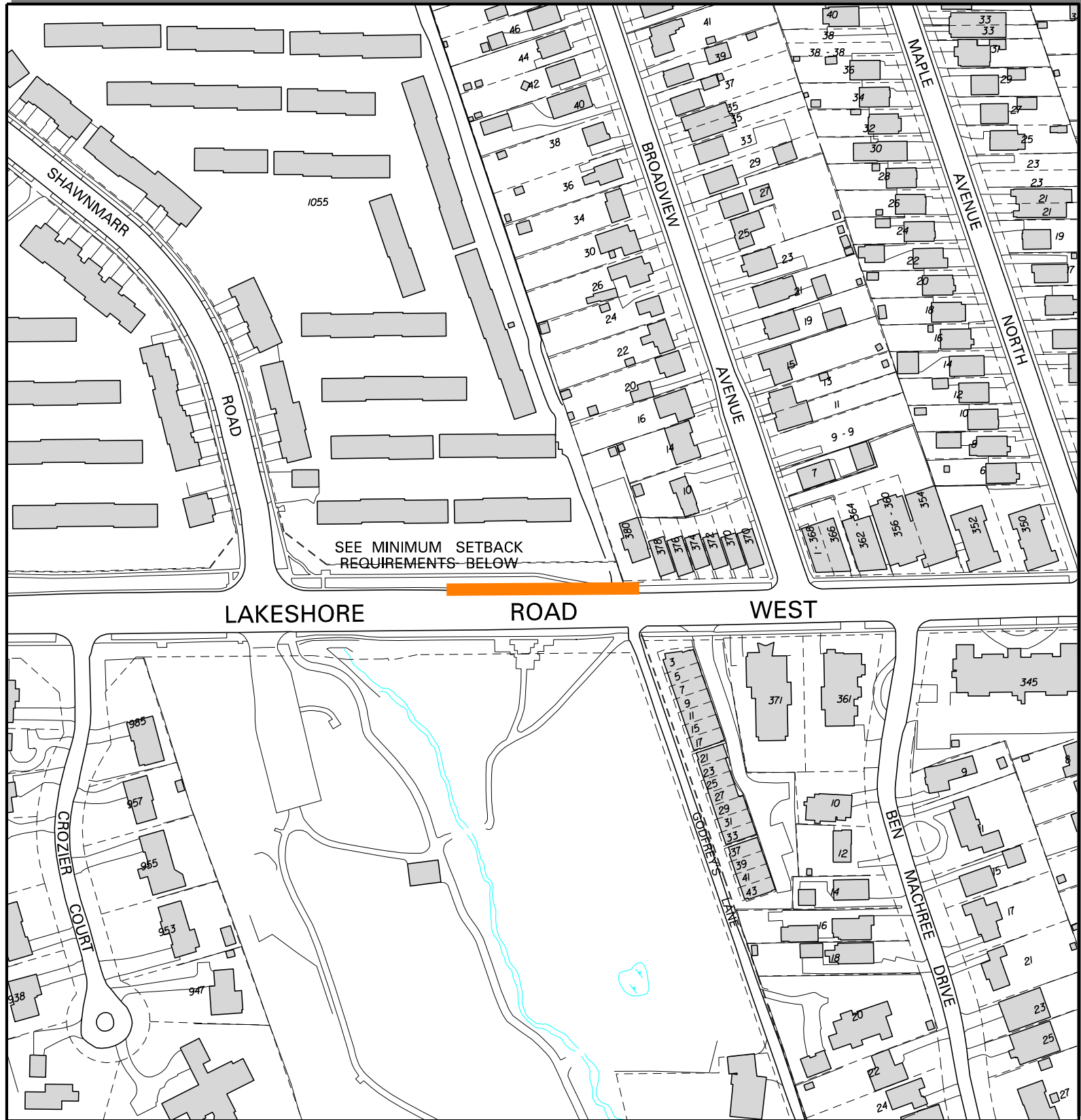

SITE No. 0904 – WARD COUNCILLOR

MINIMUM SETBACK REQUIREMENTS

	Arterial/Major Collector Roads	Collector/Local Roads
Minimum Setback from Sidewalk	1.0 metres (3 feet)	1.0 metres (3 feet)
Minimum Setback from Curb/Shoulder	1.5 metres (5 feet)	1.5 metres (5 feet)
Minimum Distance from Intersection	70 metres (230 feet)	45 metres (148 feet)
Minimum Distance from Driveway	70 metres (230 feet)	45 metres (148 feet)
Minimum Distance between Portable Signs	90 metres (300 feet) (on same side of the street)	90 metres (300 feet) (on same side of the street)

Proposed Sign Location

The portable sign shall be placed so as not to obstruct:

- the sight lines of any pedestrian, cyclist, or motorist; or
- visibility of any traffic sign or device; or
- visibility of a bus stop or bus shelter; or
- maintenance activities on the road allowance.

NOTE: This site is represented by a coloured dot on Portable Sign Location Map Z-09. This map can be viewed on the City's Web Site at <http://www.mississauga.ca/portals/services/maps>

PRODUCED FOR THE PLANNING AND BUILDING DEPARTMENT
By CPS, Geospatial Solutions

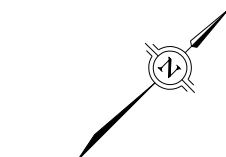

 **MISSISSAUGA**

Revised: 2021 April

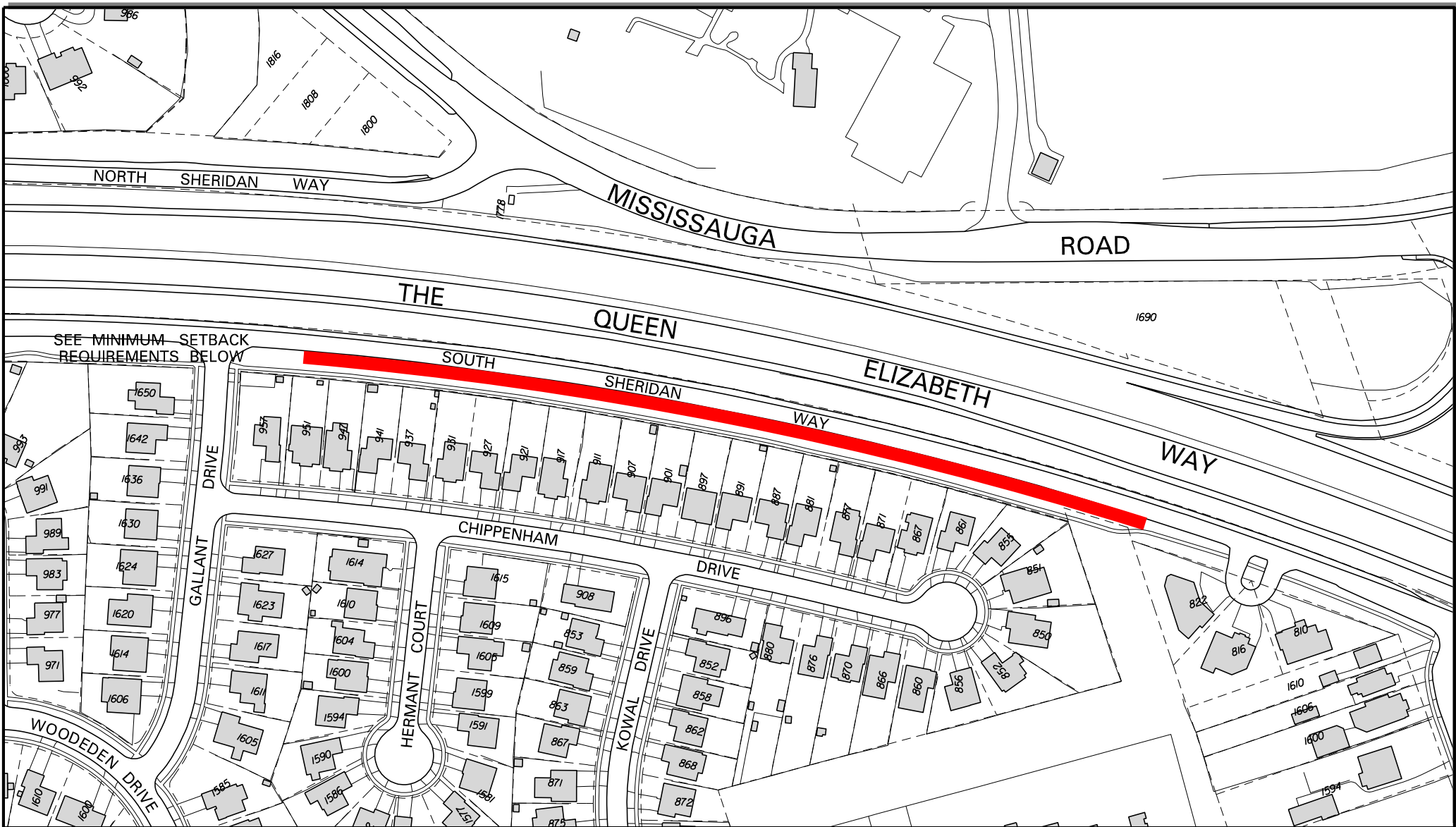

SITE No. 0905 – DELINEATED ROAD ALLOWANCE

MINIMUM SETBACK REQUIREMENTS

	Arterial/Major Collector Roads	Collector/Local Roads
Minimum Setback from Sidewalk	1.0 metres (3 feet)	1.0 metres (3 feet)
Minimum Setback from Curb/Shoulder	1.5 metres (5 feet)	1.5 metres (5 feet)
Minimum Distance from Intersection	70 metres (230 feet)	45 metres (148 feet)
Minimum Distance from Driveway	70 metres (230 feet)	45 metres (148 feet)
Minimum Distance between Portable Signs	90 metres (300 feet) (on same side of the street)	90 metres (300 feet) (on same side of the street)

Proposed Sign Location

The portable sign shall be placed so as not to obstruct:

- the sight lines of any pedestrian, cyclist, or motorist; or
- visibility of any traffic sign or device; or
- visibility of a bus stop or bus shelter; or
- maintenance activities on the road allowance.

NOTE: This site is located on Portable Sign Location Map Z-09.
The map can be viewed on the City's Web Site at
<http://www.mississauga.ca/portal/services/maps>

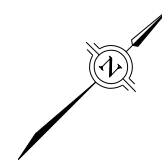

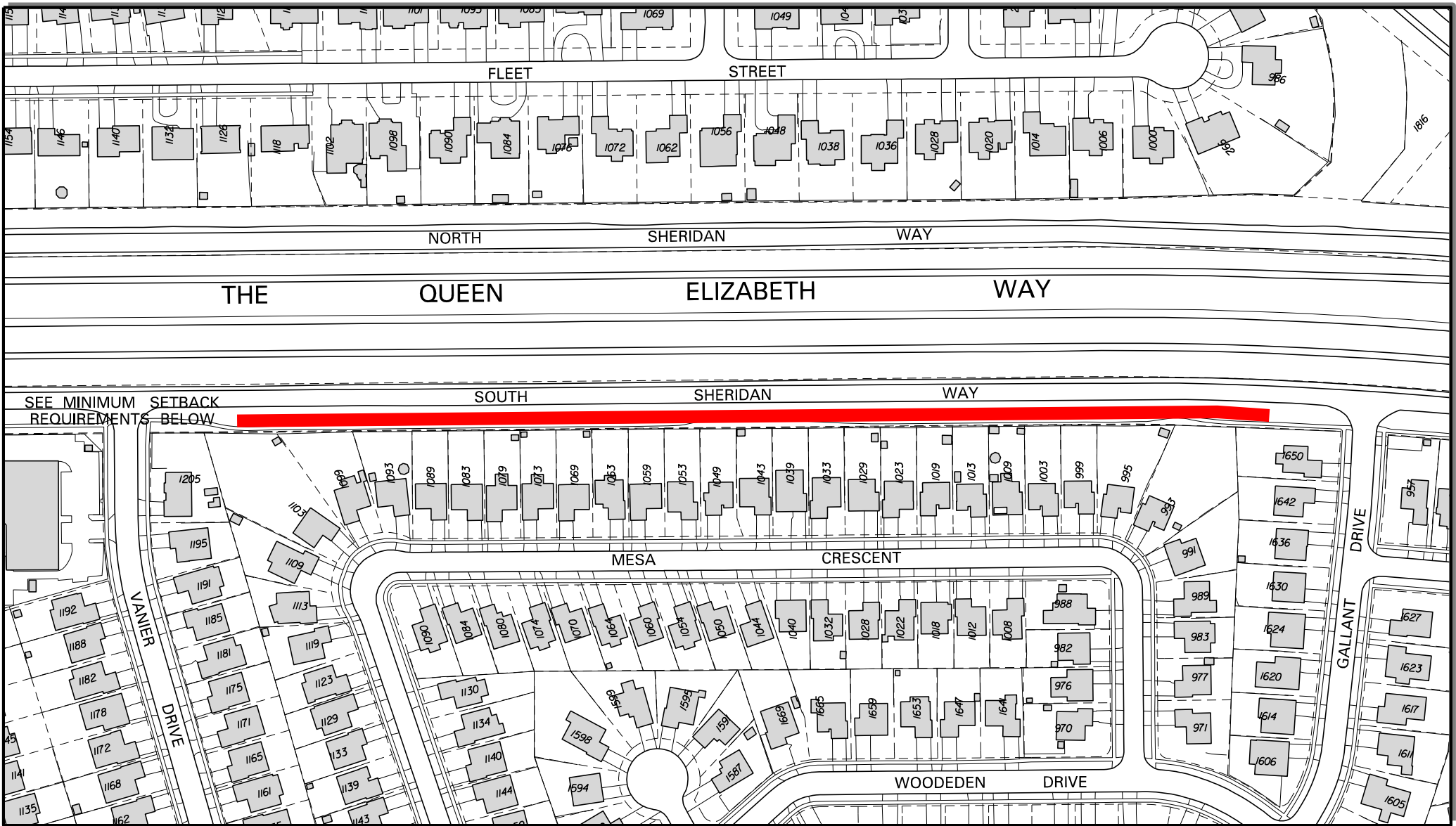

SITE No. 0906 – DELINEATED ROAD ALLOWANCE

MINIMUM SETBACK REQUIREMENTS		
	Arterial/Major Collector Roads	Collector/Local Roads
Minimum Setback from Sidewalk	1.0 metres (3 feet)	1.0 metres (3 feet)
Minimum Setback from Curb/Shoulder	1.5 metres (5 feet)	1.5 metres (5 feet)
Minimum Distance from Intersection	70 metres (230 feet)	45 metres (148 feet)
Minimum Distance from Driveway	70 metres (230 feet)	45 metres (148 feet)
Minimum Distance between Portable Signs	90 metres (300 feet) (on same side of the street)	90 metres (300 feet) (on same side of the street)



Proposed Sign Location

- The portable sign shall be placed so as not to obstruct:
- the sight lines of any pedestrian, cyclist, or motorist; or
 - visibility of any traffic sign or device; or
 - visibility of a bus stop or bus shelter; or
 - maintenance activities on the road allowance.

NOTE: This site is located on Portable Sign Location Map Z-09. The map can be viewed on the City's Web Site at <http://www.mississauga.ca/portal/services/maps>

